

1 00 - Ground Floor
1 : 100

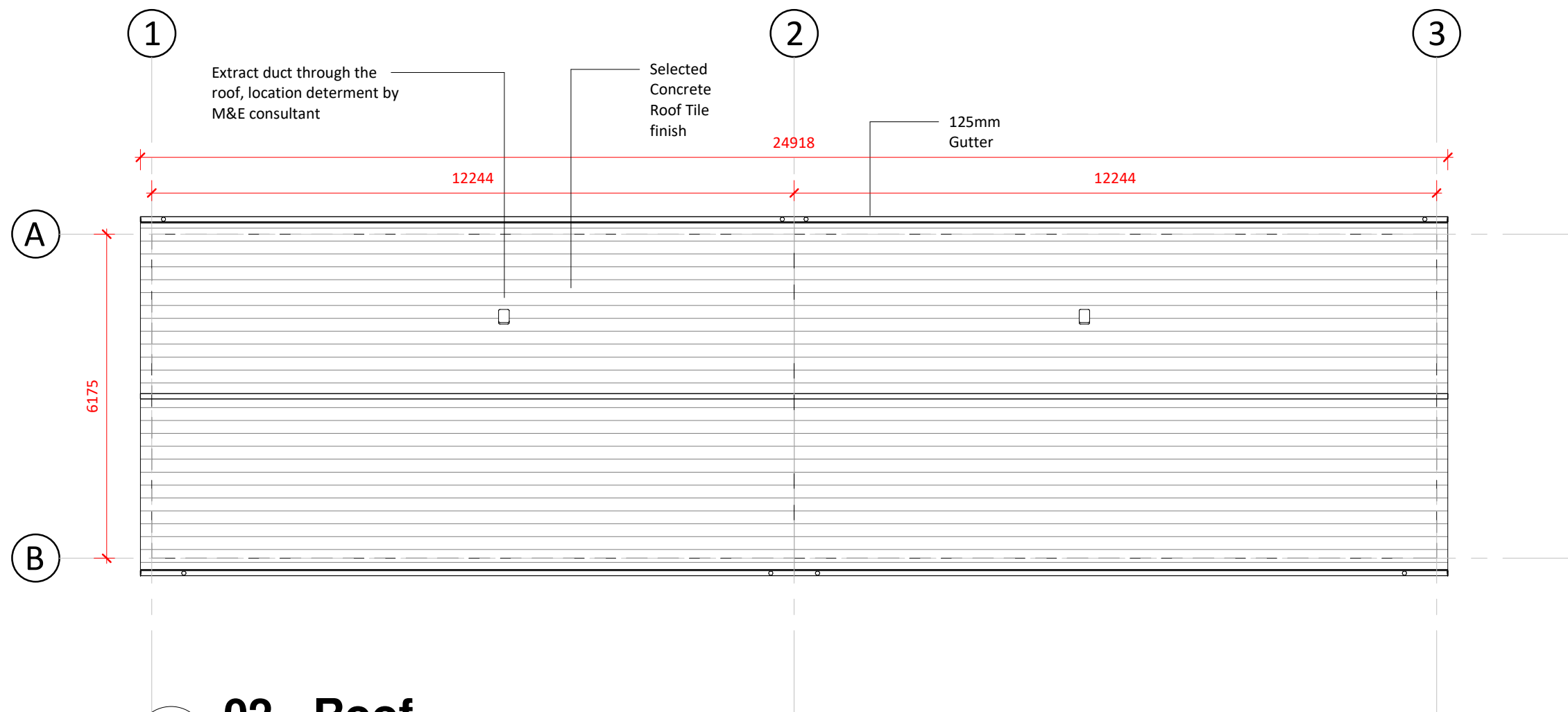

2 02 - Roof
1 : 100

GENERAL NOTES:

- A. THIS DRAWING IS TO BE READ IN CONJUNCTION WITH ALL RELEVANT ARCHITECTURAL DRAWINGS, THE SPECIFICATION, AND ALL RELEVANT STANDARD DETAIL DRAWINGS.
- B. THIS DRAWING IS TO BE READ IN CONJUNCTION WITH ALL RELEVANT CIVIL, STRUCTURAL, MECHANICAL AND ELECTRICAL DRAWINGS TOGETHER WITH THE SPECIFICATIONS AND SCHEDULES.
- C. ALL DIMENSIONS IN MILLIMETRES. DO NOT SCALE FROM THIS DRAWING. USE FIGURED DIMENSIONS ONLY.
- D. CONTRACTOR MUST VERIFY ALL DIMENSIONS ON SITE BEFORE SETTING OUT, COMMENCING WORK, OR PRODUCING ANY SHOP DRAWINGS.

Quality Housing Area Breakdown - 2 Bed 3 Person - Type A		
Room Name/Area	Proposed Area	DoE standards minimum
Gross Floor Area	65 m ²	60 m ²
Kitchen/Living/Dining	28 m ²	28 m ²
Bedroom No 1	13.1 m ²	13 m ²
Bedroom No 2	7.1 m ²	7.1 m ²
Storage	3 m ²	3 m ²

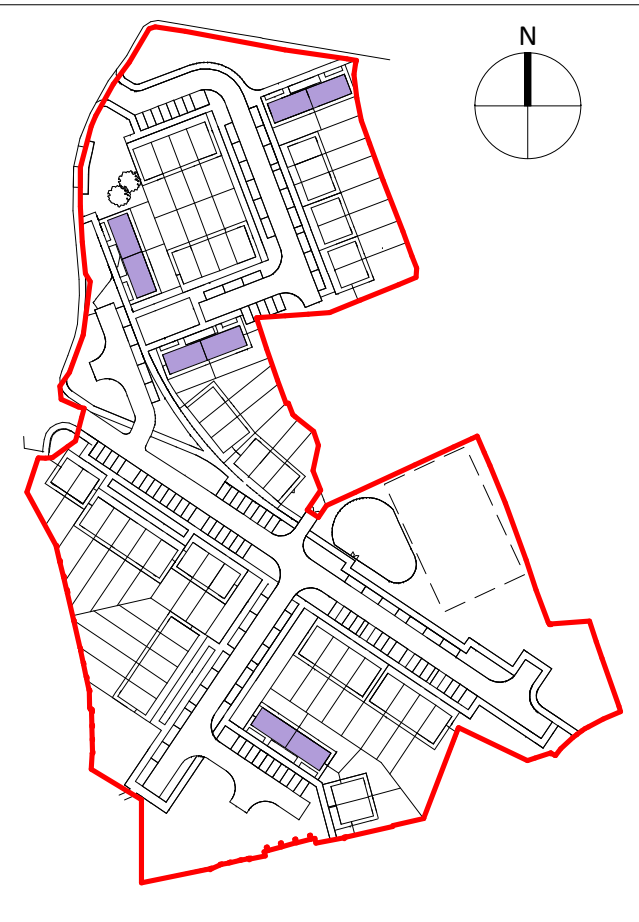

KEY PLAN

Rev	Description	By	Ckd	Date

eml
architects

20 Cruises Street
Limerick
V94 R6P9
Ireland
(061) 312249
limerick@eml.ie
www.eml.ie

37 Fitzwilliam Pl.
Dublin 2
D02 YT52
Ireland
(01) 6707677
dublin@eml.ie



Client	Date
Cluid Housing	14/03/22
Job	Scale @ A2 As indicated
3553 - Hepburn Court	Drawn by NOC
	Checked by TMC

Sheet Title				
2B3P Type A House - Elevations and Section (Block A, G, H, & P)				
Job No. 3553	Stage PL	Drawing No. 3553-EML-ZZ-ZZ-DR-A-101 Project - Originator - Zone - Level - Doc Type - Role - Number	Suitability	Rev