

ESTATE ROAD CONSTRUCTION:

25mm OF 10mm WEARING COURSE BITUMEN MACADAM TO BS1621 ON
40mm OF 20mm BASECOURSE BITUMEN MACADAM TO BS1621 ON
80mm OF 40mm DENSE BITUMEN ROADBASE TO CLAUSE 812 ON
150mm CLAUSE 804 SUB-BASE ON
X CLAUSE 616 CAPPING LAYER
(NOTE 150 + X = 300mm Min. 600mm Max. DEPENDING ON CBR TESTS)
THE CONTRACTOR IS TO ALLOW IN HIS TENDER FOR 1 CBR TEST PER 100m OF ROADWAYS.

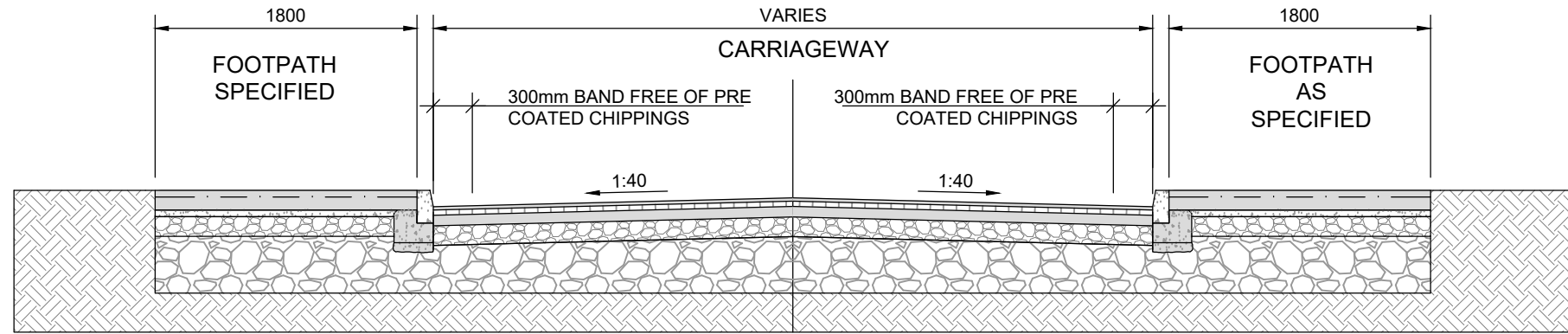

1 TYPICAL CROSS SECTION THRO ESTATE ROAD AND FOOTPATH
205/207

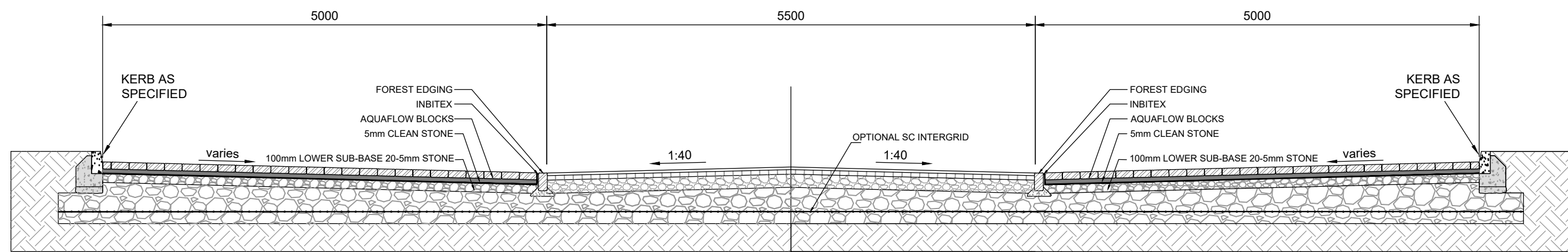

2 TYPICAL CROSS SECTION THRO CAR PARK
205/207

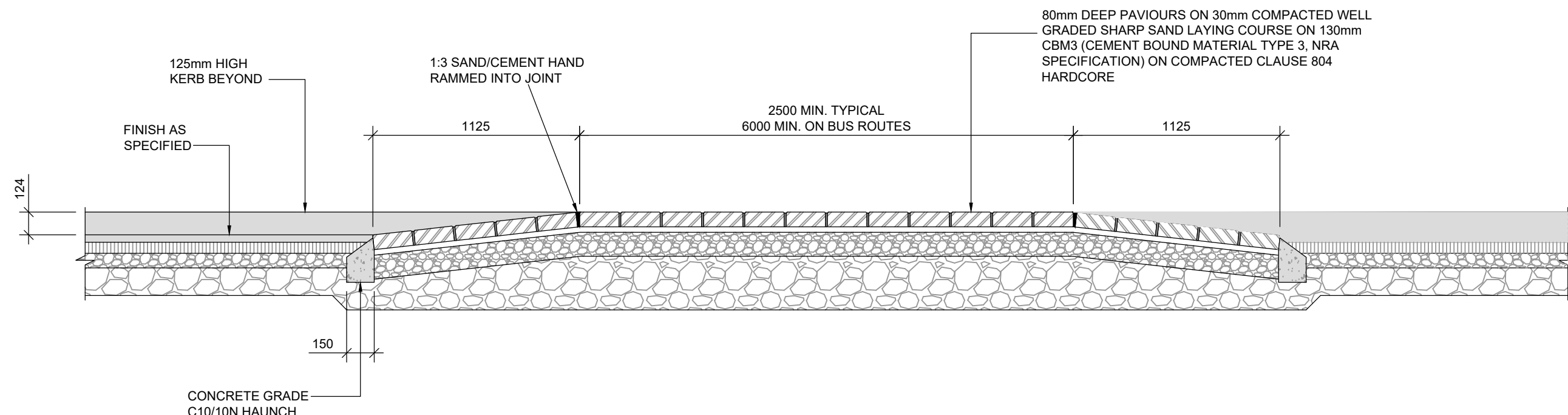

3 TYPICAL SECTION THRO' RAISED ROAD TABLE
205/207

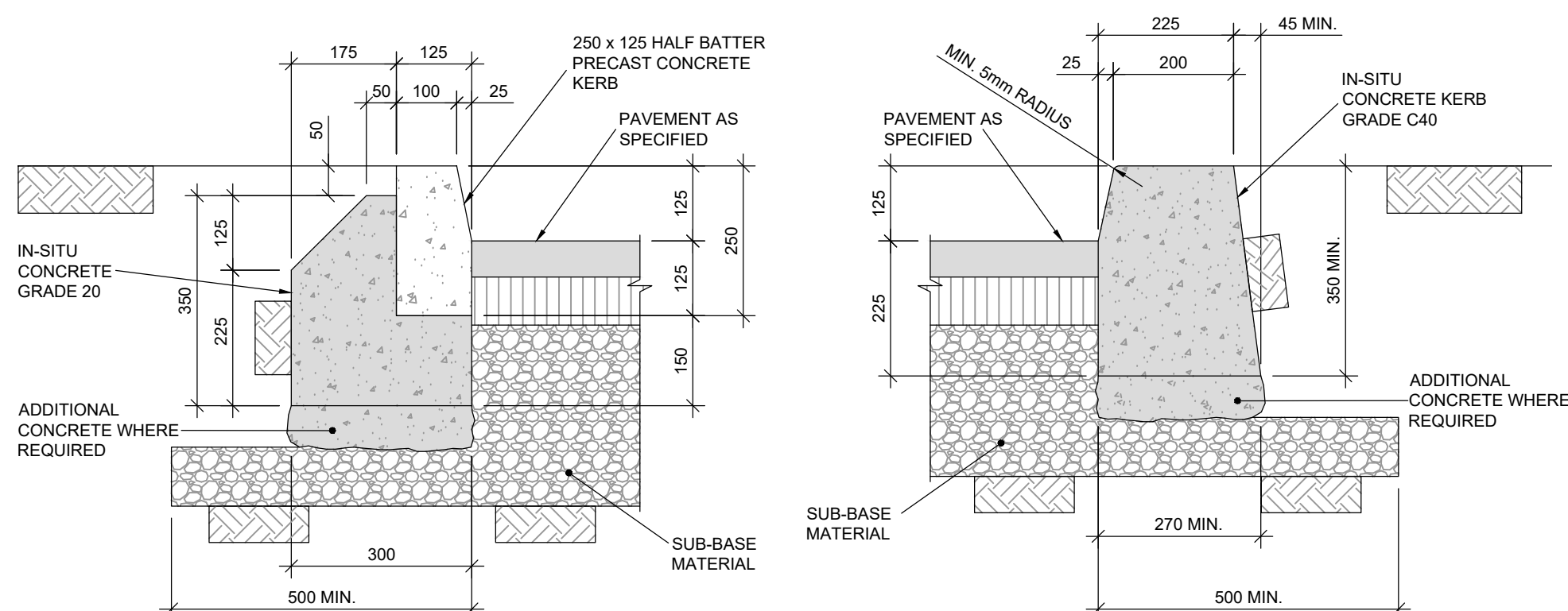

5A PRECAST KERB
205/207

5B IN-SITU KERB
205/207

5 TYPICAL KERB DETAILS
205/207

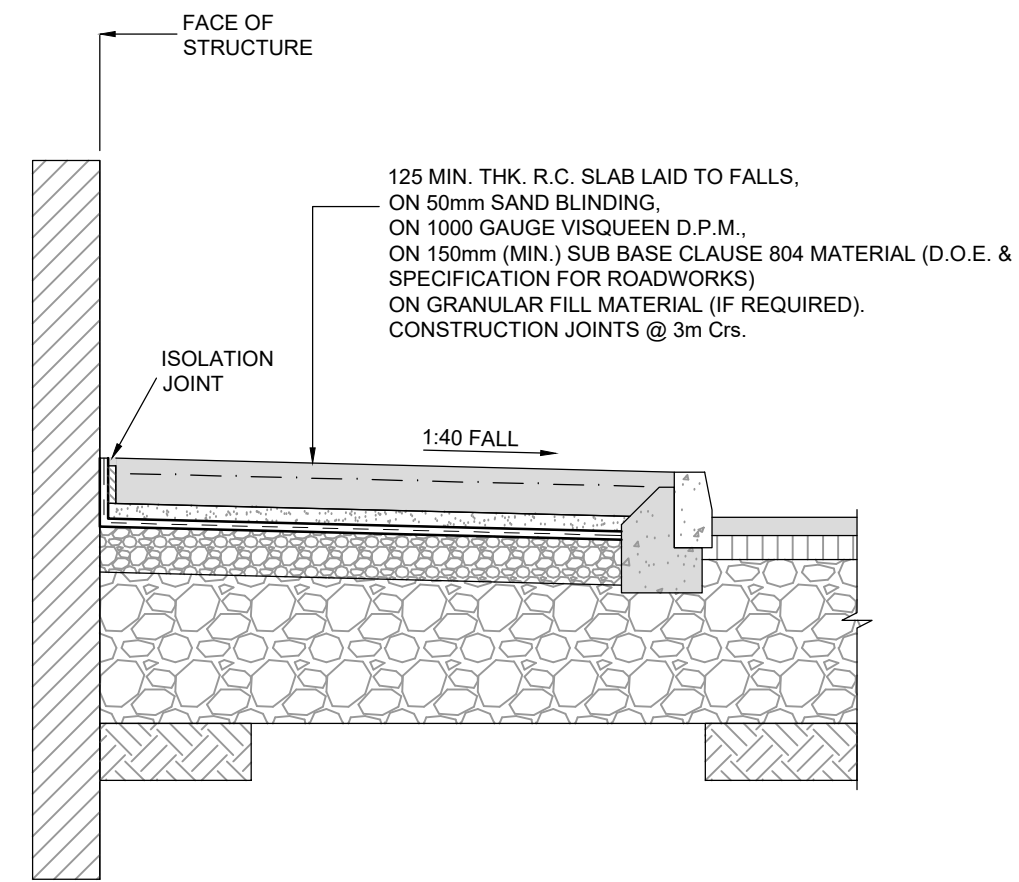

TYPICAL SECTION THRO' CONCRETE FOOTPATH ADJACENT TO BUILDING

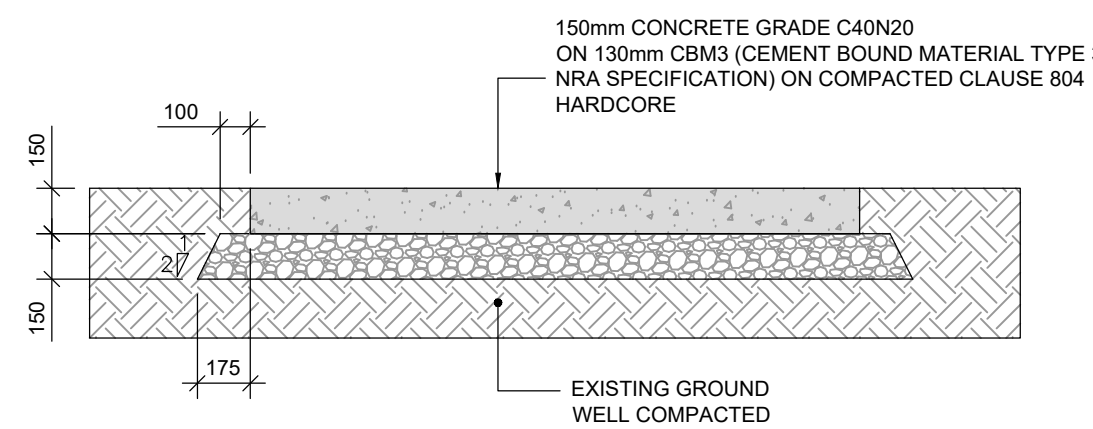

TYPICAL SECTION THRO' CONCRETE FOOTPATH

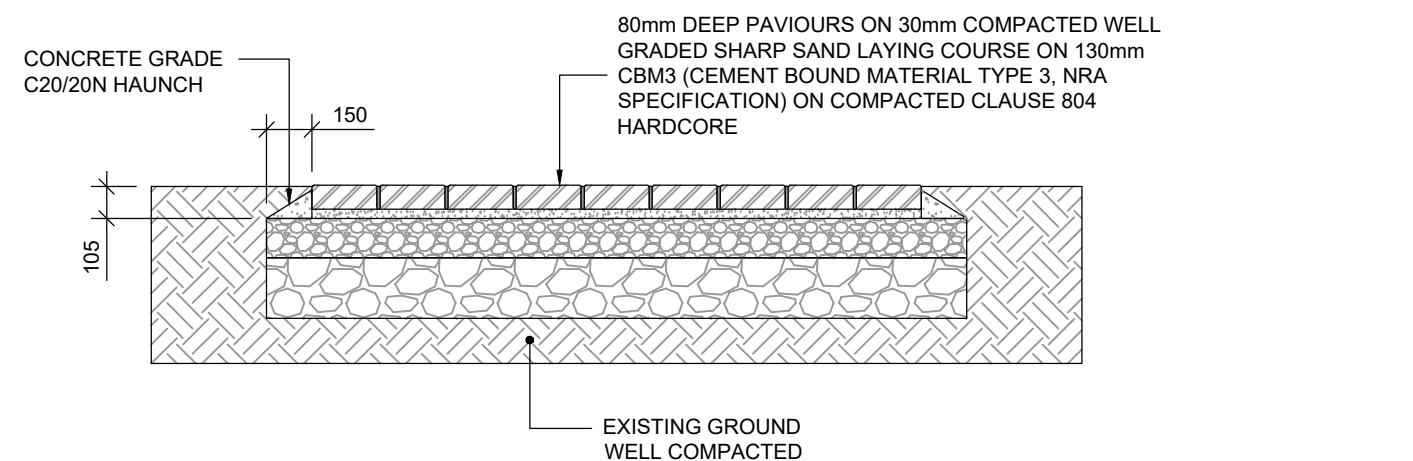

TYPICAL SECTION THRO' BLOCK PAVIOUR FOOTPATH

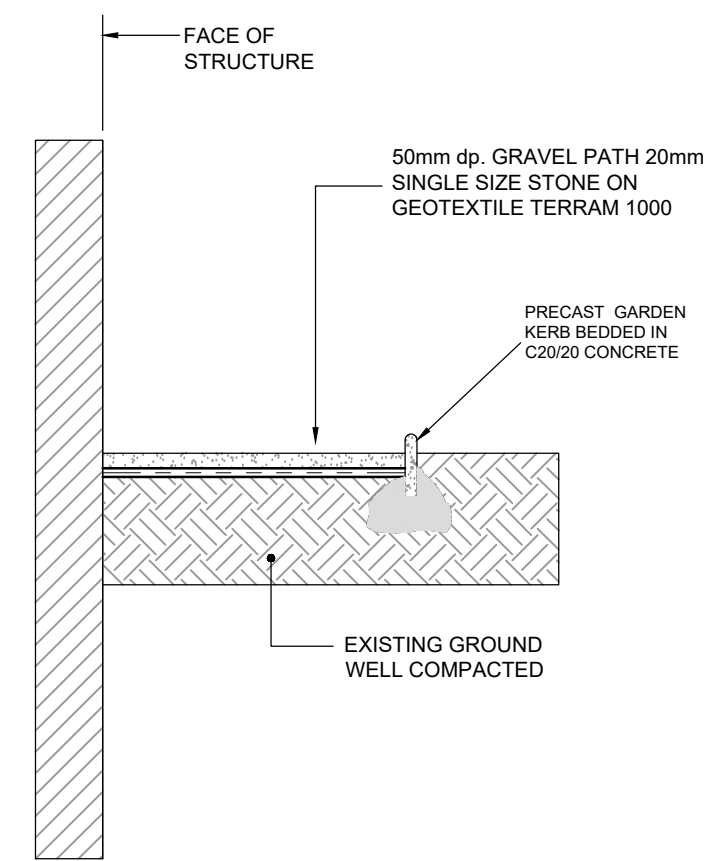

TYPICAL SECTION THRO' GRAVEL FOOTPATH

4 TYPICAL FOOTPATH DETAILS
205/207

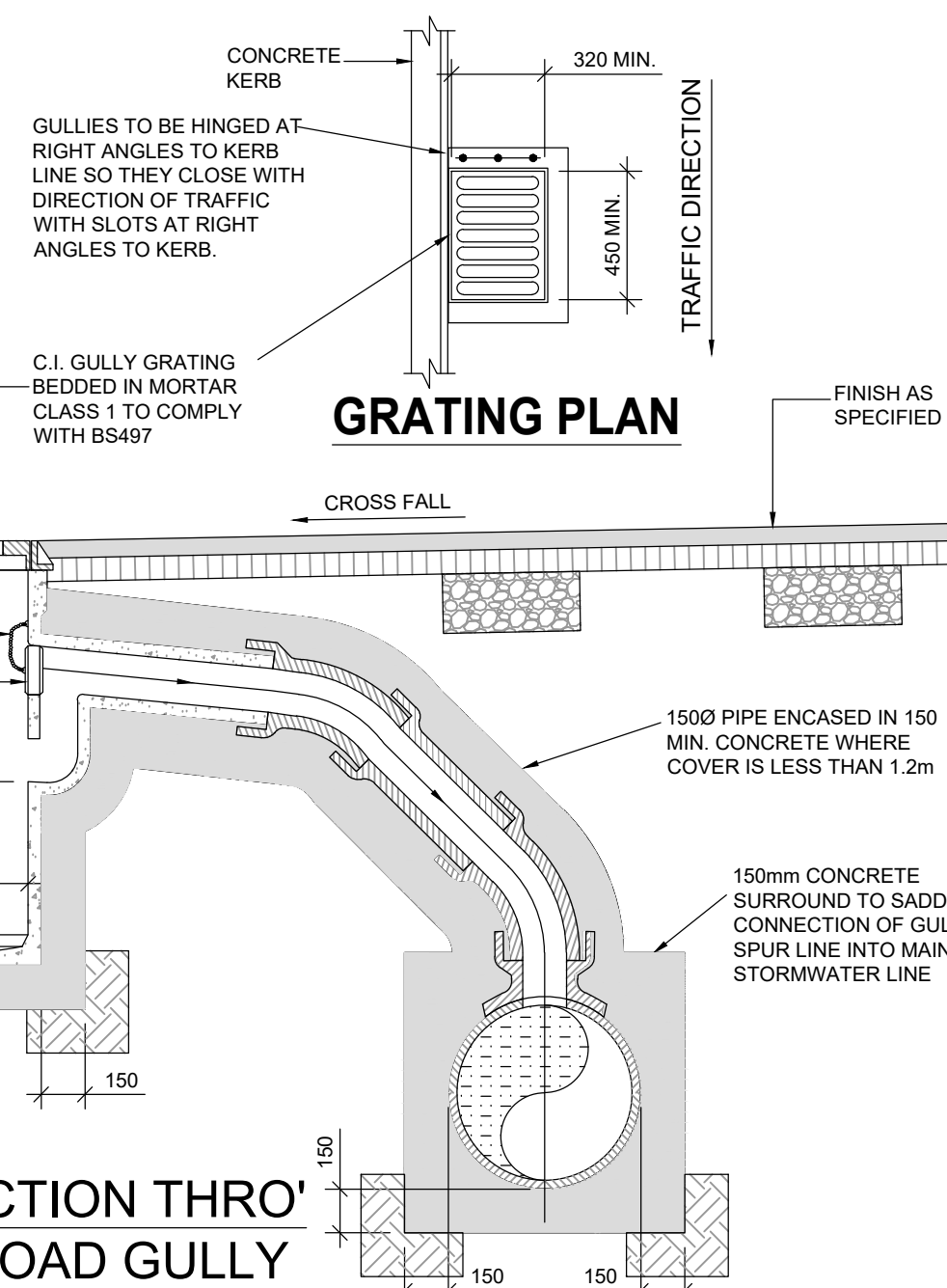

6A TYPICAL SECTION THRO' PRECAST ROAD GULLY
205/207

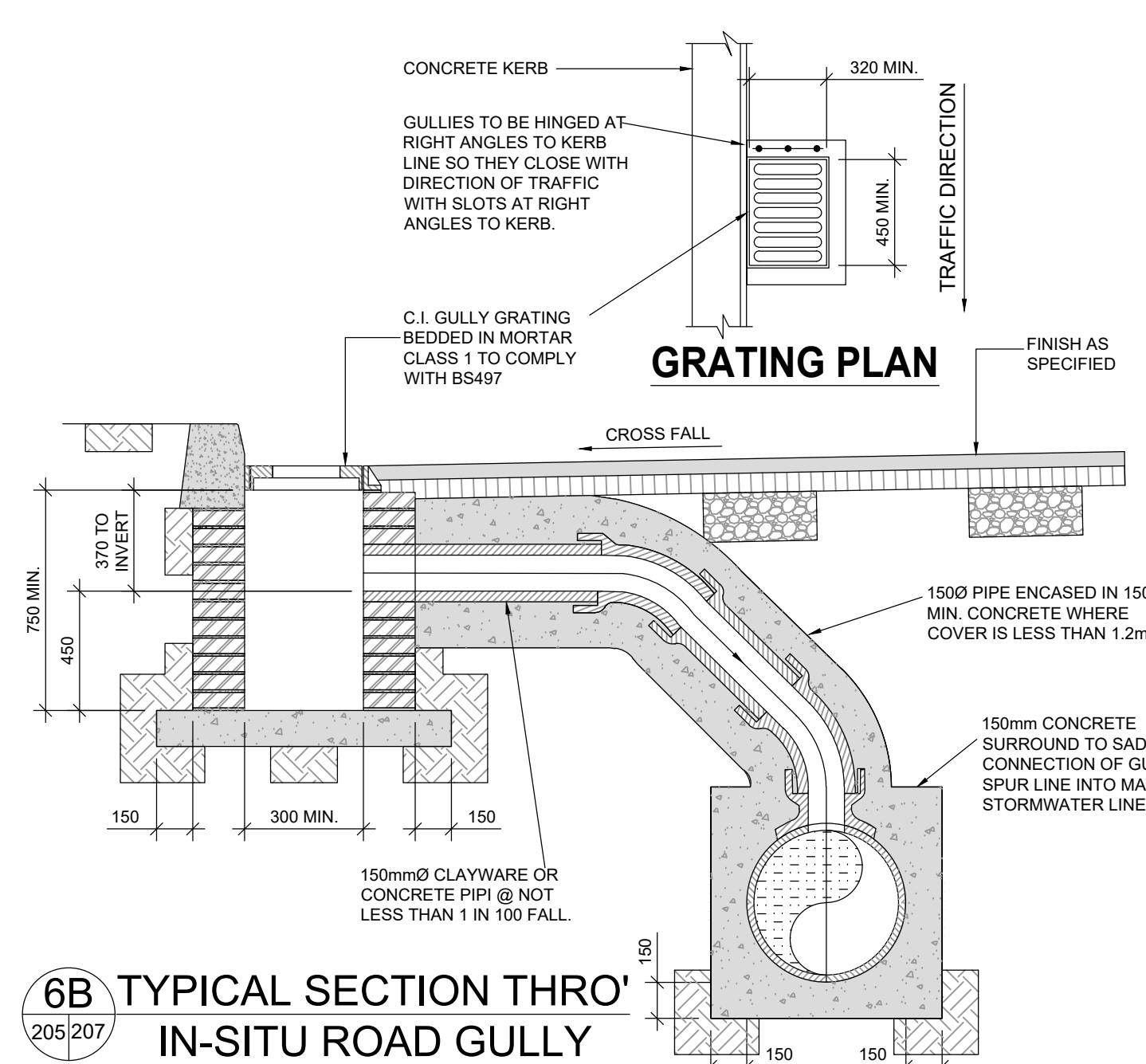

6B TYPICAL SECTION THRO' IN-SITU ROAD GULLY
205/207

6 TYPICAL ROAD GULLY DETAILS
205/207

NOTES

- THIS DRAWING IS TO BE READ IN CONJUNCTION WITH ALL ENGINEERS' & ARCHITECTS' DRAWINGS. FIGURED DIMENSIONS ONLY (NOT SCALING) TO BE USED. WHERE A CONFLICT OF INFORMATION EXISTS OR IF IN ANY DOUBT - ASK.
- CONSULTANTS TO BE INFORMED IMMEDIATELY OF ANY DISCREPANCIES BEFORE WORK PROCEEDS.

NOT FOR CONSTRUCTION

PL03	18.03.20	ISSUED FOR PLANNING	A.W.	J.R.
PL02	16.03.20	ISSUED FOR PLANNING	A.W.	J.R.
PL01	04.03.20	ISSUED FOR PRE-PLANNING	A.W.	J.R.
ISSUE	DATE	DESCRIPTION	DRW	ORG

Jason Redmond & Associates Consulting Engineers

Civil Structural
Project Management
5 Lisnard Court, Portlaoise,
Co. Laois.
PH: 05786 81155
Email: info@jrassc.ie

CLIENT: ARDAIN DEVELOPMENTS

PROJECT: PROPOSED RESIDENTIAL DEVELOPMENT AT RAILWAY ST. PORTLAOISE, CO. LAOIS

TITLE: ROADS & CAR PARK SECTIONS AND DETAILS

DATE: 04.03.2020	SCALE @ A1: NTS
DRAWING TITLE: 17.168-207	REVISION: PL03

THIS DRAWING IS COPYRIGHT AND SHOULD NOT BE REPRODUCED IN WHOLE OR IN PART WITHOUT THE WRITTEN PERMISSION OF JASON REDMOND AND ASSOCIATES. THIS DRAWING SHOULD NOT BE SCALED AND ONLY FIGURED DIMENSIONS ARE TO BE WORKED FROM. ANY DISCREPANCY IS TO BE REFERRED TO JASON REDMOND AND ASSOCIATES BEFORE PROCEEDING.

DWG LOCATION: Z:\DRAWINGS\1717-168 RAILWAY STREET SITE\JRA\0326 CURRENT\17-168-207 ROAD DETAILS