

Meehan House
James Fintan Lalor Avenue
Portlaoise
Co Laois

T (057) 862 1787
F (057) 862 1467
E sales@grahamdevelopments.ie
www.grahamdevelopments.ie

**Mr. Simon Walton,
Director of Services,
Laois County Council,
Áras an Chontae,
James Fintan Lalor Avenue,
Portlaoise, Co. Laois**

2nd Day of January 2024

Re: Triogue Way Phase 2 Part VIII Planning

We, Grahams Builders Ltd., hereby consent to Laois County Council making a Part VIII Planning Application for the Triogue Way Phase 2 on our lands located in Maryborough, Portlaoise, Co. Laois.

The lands concerned are located within Folios LS 35412F, LS 2764F & LS 33375F and are shown marked A on the attached third party land requirement map attached.

Yours sincerely,

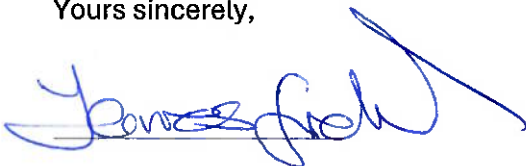

James Graham



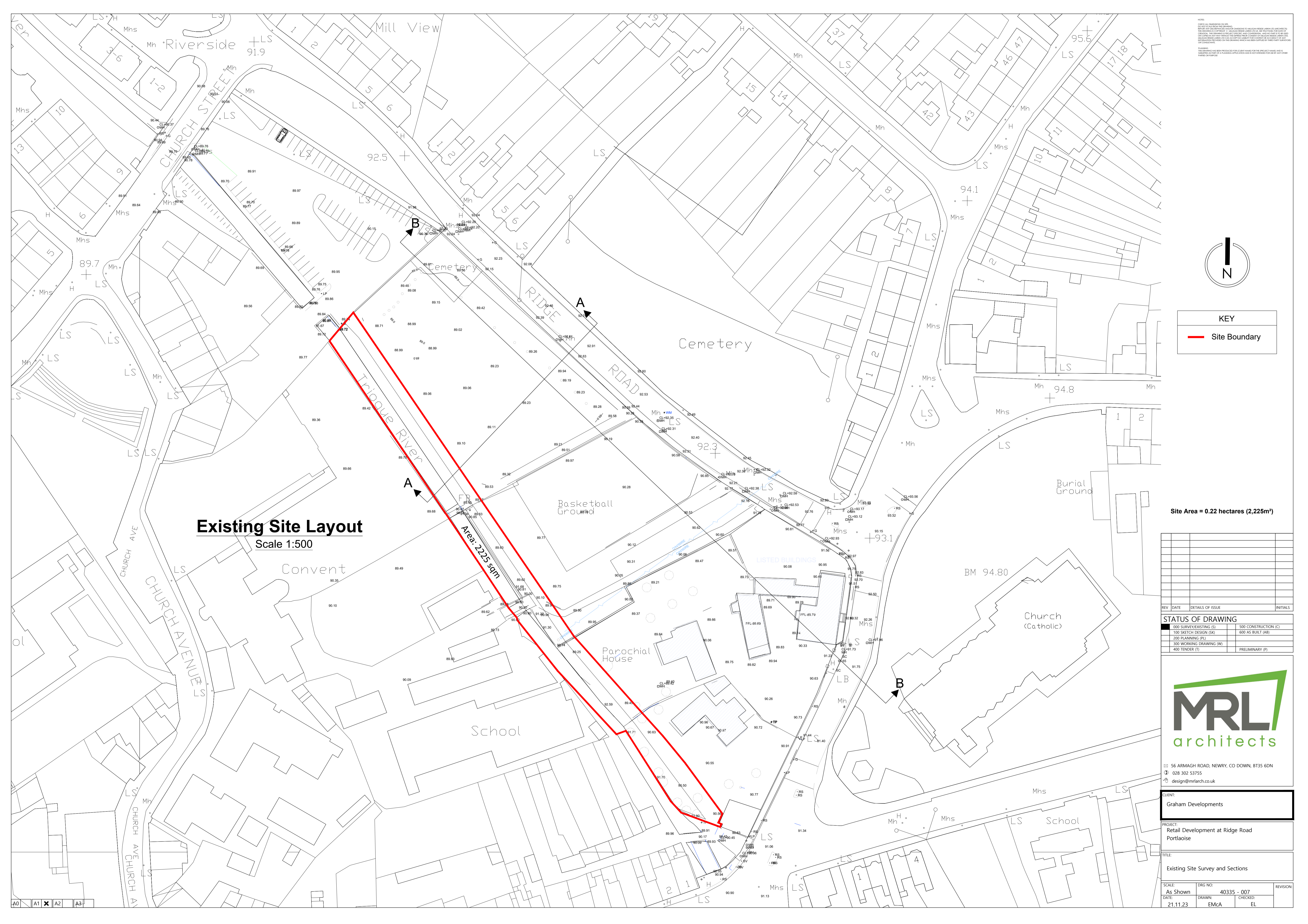

Existing Site Layout
Scale 1:500

Area: 225 sqm

NOTES:
CHECK ALL DIMENSIONS ON THIS DRAWING.
DO NOT SCALE DIMENSIONS.
THE DRAWING IS CONTROLLED BY THE ARCHITECT.
NO PART OF THIS DRAWING IS TO BE REPRODUCED OR TRANSMITTED IN ANY FORM OR BY ANY MEANS, ELECTRONIC OR MECHANICAL, INCLUDING PHOTOCOPYING, RECORDING, OR BY ANY INFORMATION STORAGE AND RETRIEVAL SYSTEM, WITHOUT THE WRITTEN PERMISSION OF THE ARCHITECT.
PLANNING: THIS DRAWING IS FOR INFORMATION ONLY AND DOES NOT REPRESENT A COMMITMENT BY THE ARCHITECT.
CONSTRUCTION: THIS DRAWING IS FOR INFORMATION ONLY AND DOES NOT REPRESENT A COMMITMENT BY THE ARCHITECT.

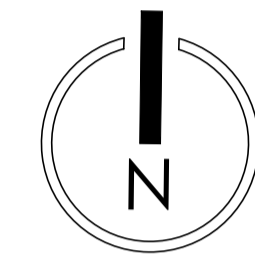

KEY
— Site Boundary

Site Area = 0.22 hectares (2,225m²)

REV	DATE	DETAILS OF ISSUE	INITIALS

STATUS OF DRAWING

000 SURVEY/EXISTING (S)	500 CONSTRUCTION (C)
100 SKETCH DESIGN (SK)	600 AS BUILT (AB)
200 PLANNING (PL)	
300 WORKING DRAWING (WD)	
400 TENDER (T)	PRELIMINARY (P)

MRL
architects

56 ARMAGH ROAD, NEWRY, CO DOWN, BT35 6DN
028 302 53755
design@mrlarch.co.uk

CLIENT:
Graham Developments

PROJECT:
Retail Development at Ridge Road
Portlaoise

TITLE:
Existing Site Survey and Sections

SCALE: As Shown	DRG NO: 40335 - 007	REVISION:
DATE: 21.11.23	DRAWN: EMcA	CHECKED: EL