

X=646546
Y=699337

X=646797
Y=699337

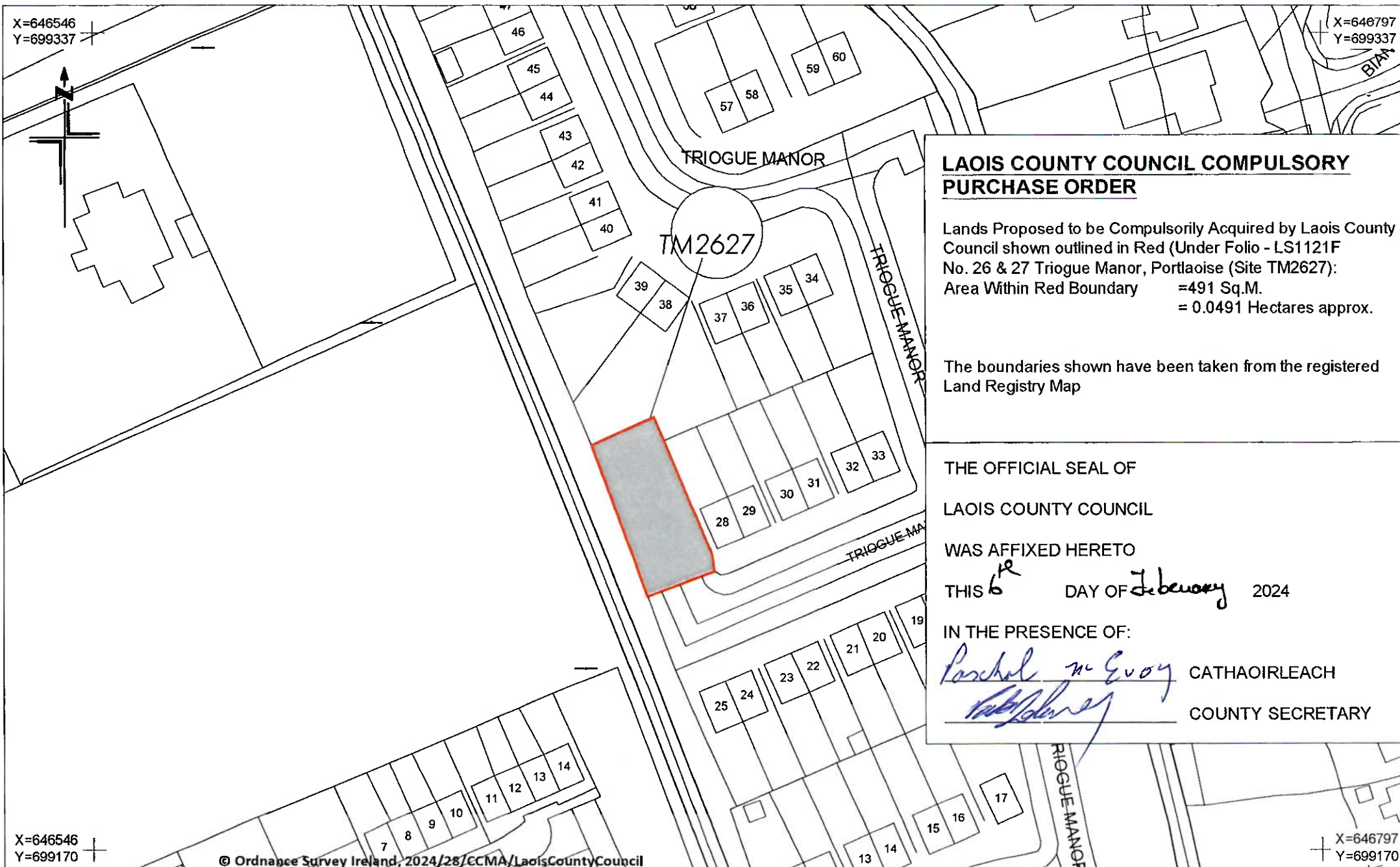
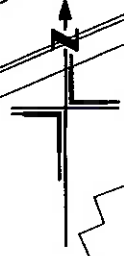

X=646546
Y=699170

X=646797
Y=699170

© Ordnance Survey Ireland, 2024/28/CCMA/LaoisCountyCouncil

LAOIS COUNTY COUNCIL COMPULSORY PURCHASE ORDER

Lands Proposed to be Compulsorily Acquired by Laois County Council shown outlined in Red (Under Folio - LS1121F No. 26 & 27 Triogue Manor, Portlaoise (Site TM2627):
Area Within Red Boundary =491 Sq.M.
= 0.0491 Hectares approx.

The boundaries shown have been taken from the registered Land Registry Map

THE OFFICIAL SEAL OF
LAOIS COUNTY COUNCIL

WAS AFFIXED HERETO
THIS 6th DAY OF February 2024

IN THE PRESENCE OF:
Patrol McEvoy CATHAOIRLEACH
Paul Shanley COUNTY SECRETARY



LAOIS COUNTY COUNCIL
PLANNING SECTION,
COUNTY HALL,
PORTLAOISE,
CO. LAOIS.
PHONE: (057) 8664000

REVISION:	DESCRIPTION	DATE:

DRAWING TITLE:
26 & 27 Triogue Manor,
Portlaoise,

Scale: 1:1000
Drawn By: CM
Ref: 2024-05
Ref. File: CPO No. 5 of 2024

Date: 16/01/2024
Checked By: DOH
Drawing No.:
CPO-LS-TM2627